

# MALDEN'S REVIVAL

---

Michelle Cordova-Ramirez

# PROJECT GOALS



# PROJECT GOALS

- Undoing zoning codes





# PROJECT GOALS

- Undoing zoning codes
- Create a complete community



# PROJECT GOALS

- Undoing zoning codes
- Create a complete community
- Meets all human needs





# PROJECT GOALS

- Undoing zoning codes
- Create a complete community
- Meets all human needs
- All within a short walking distance



# CONCEPT

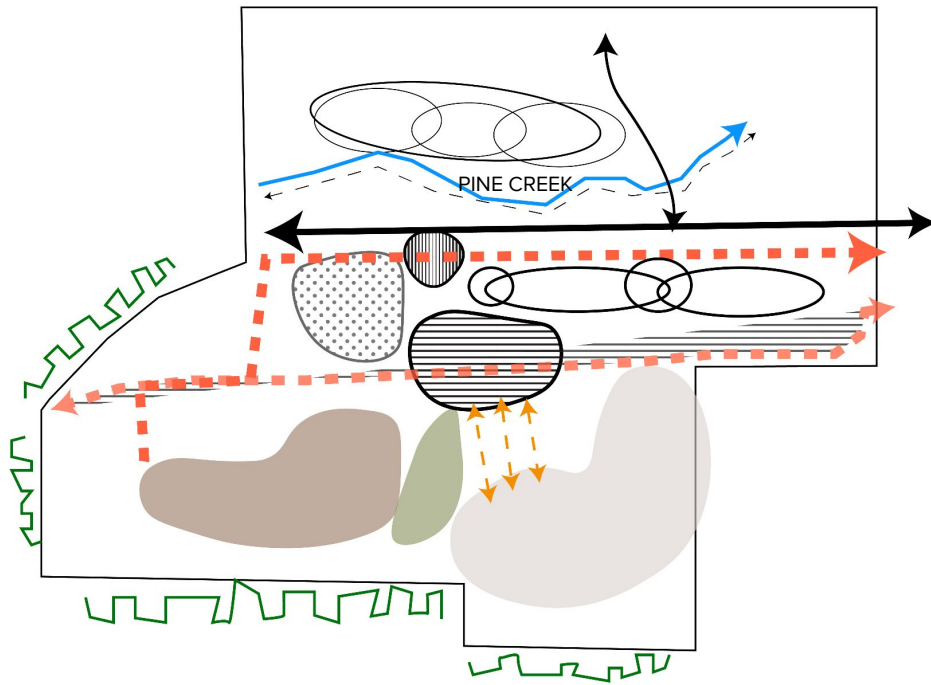

# CONCEPT

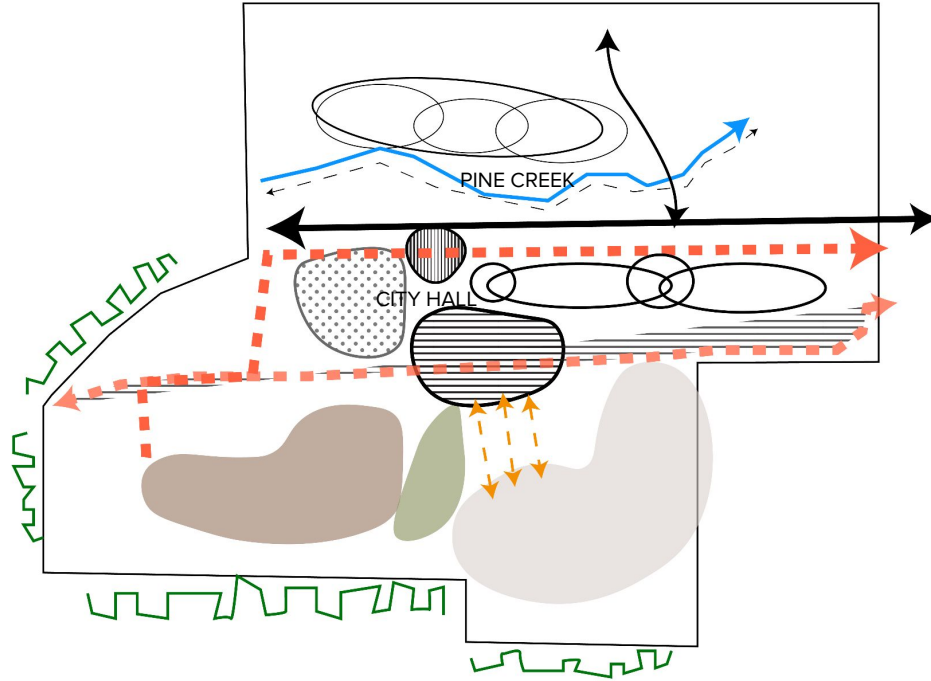



# CONCEPT

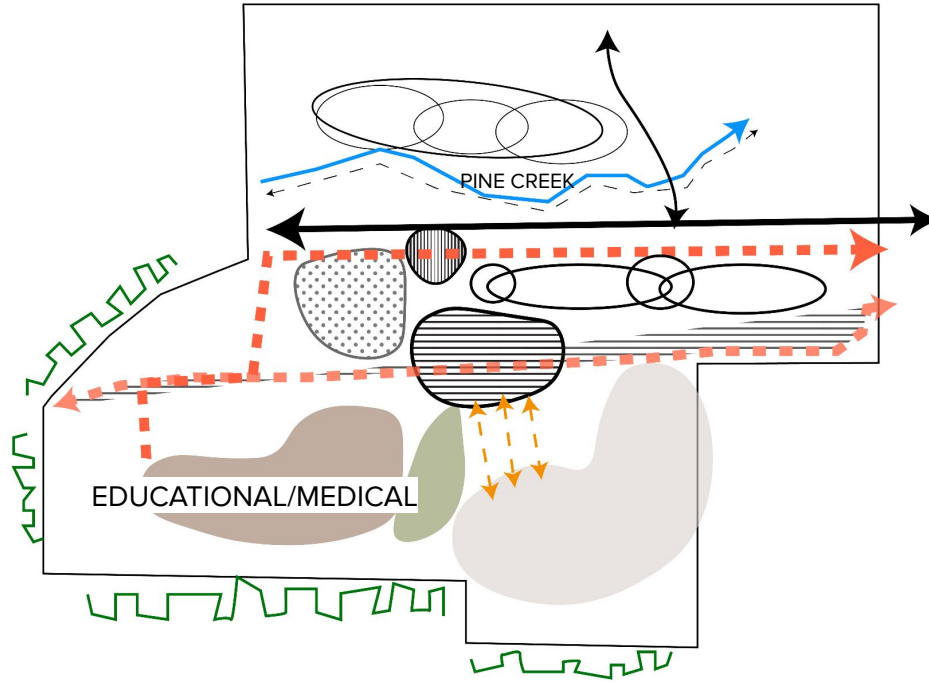

# CONCEPT

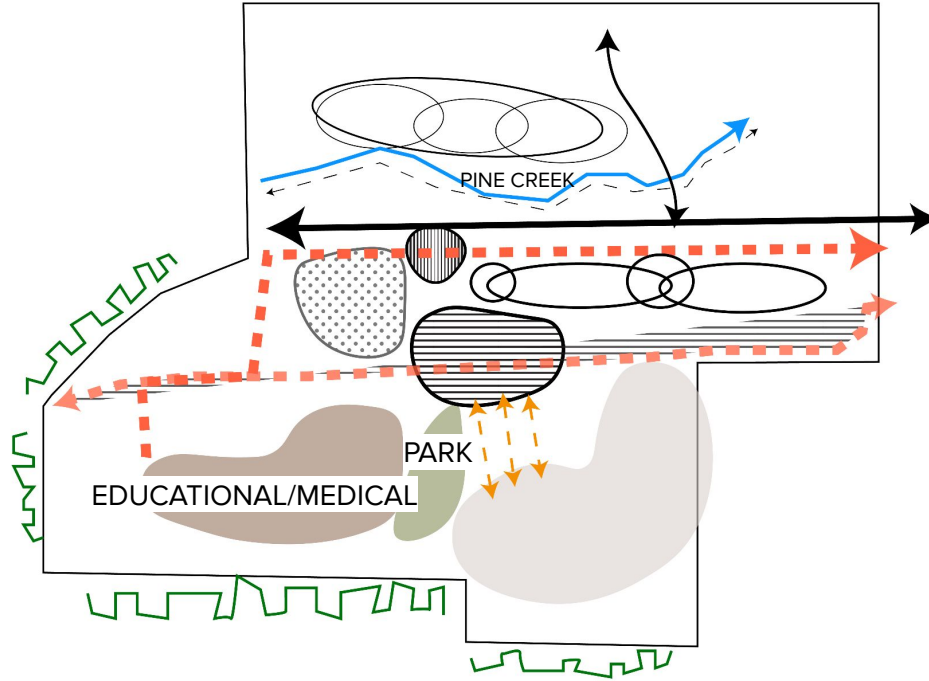

# CONCEPT

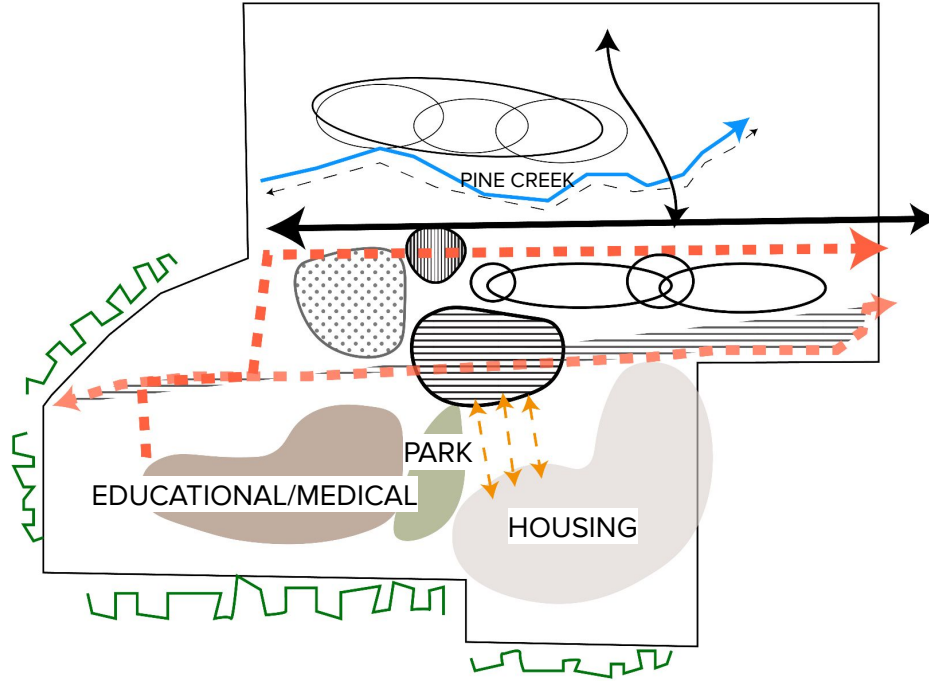

# CONCEPT

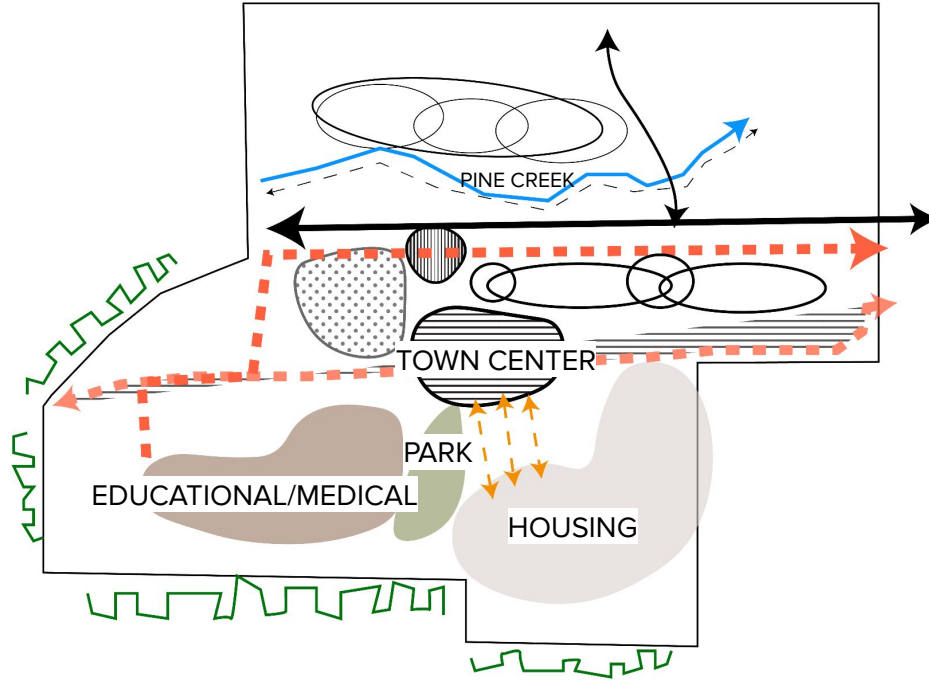



# CONCEPT

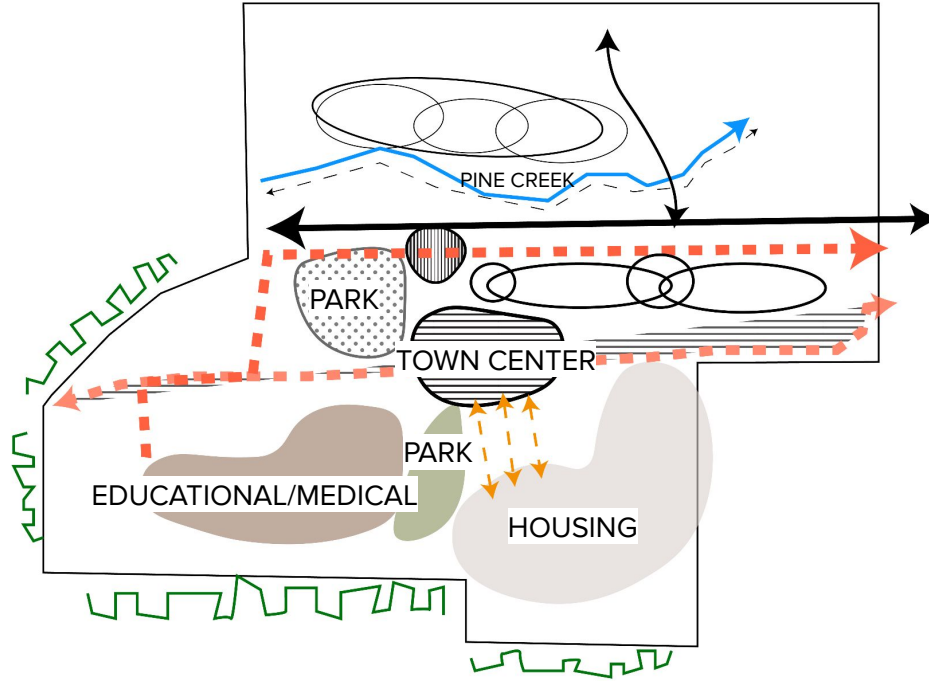

# CONCEPT

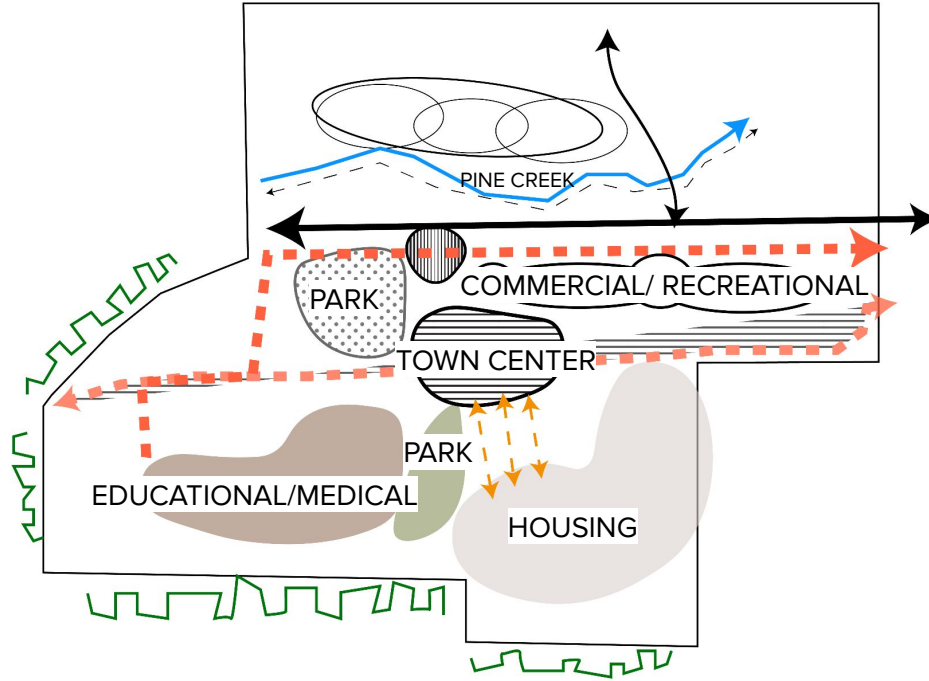

# CONCEPT

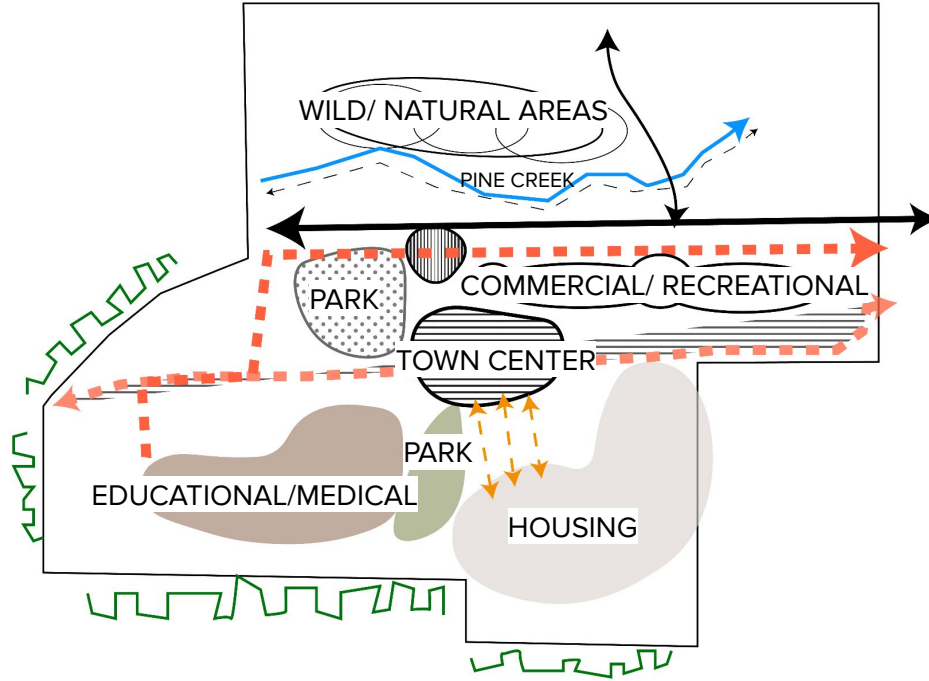

# CONCEPT

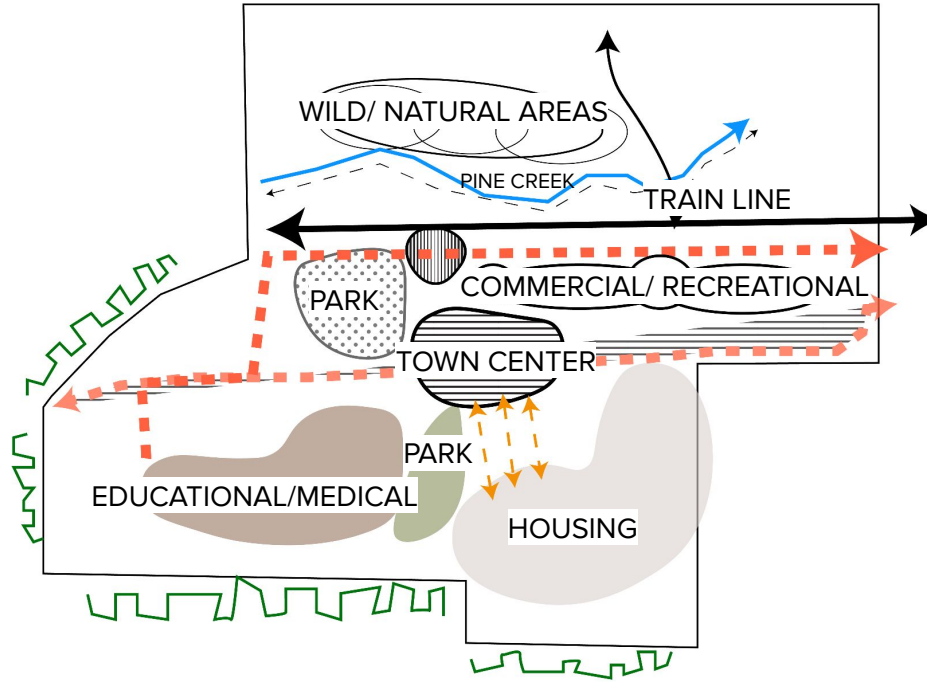



# CONCEPT

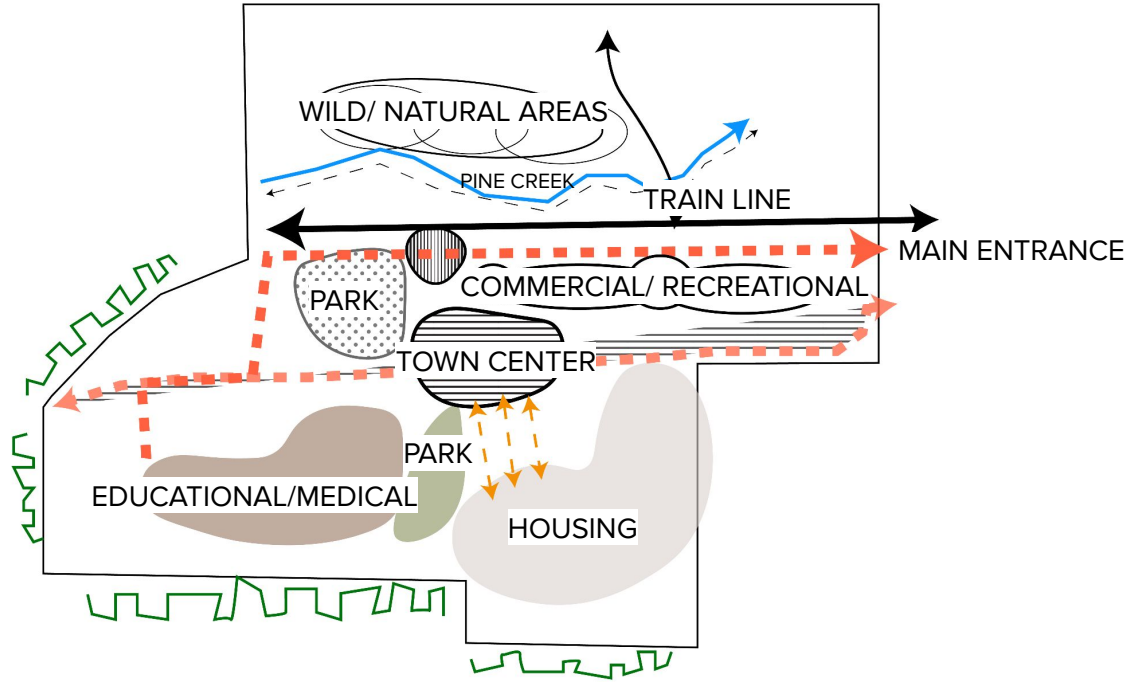

# CONCEPT

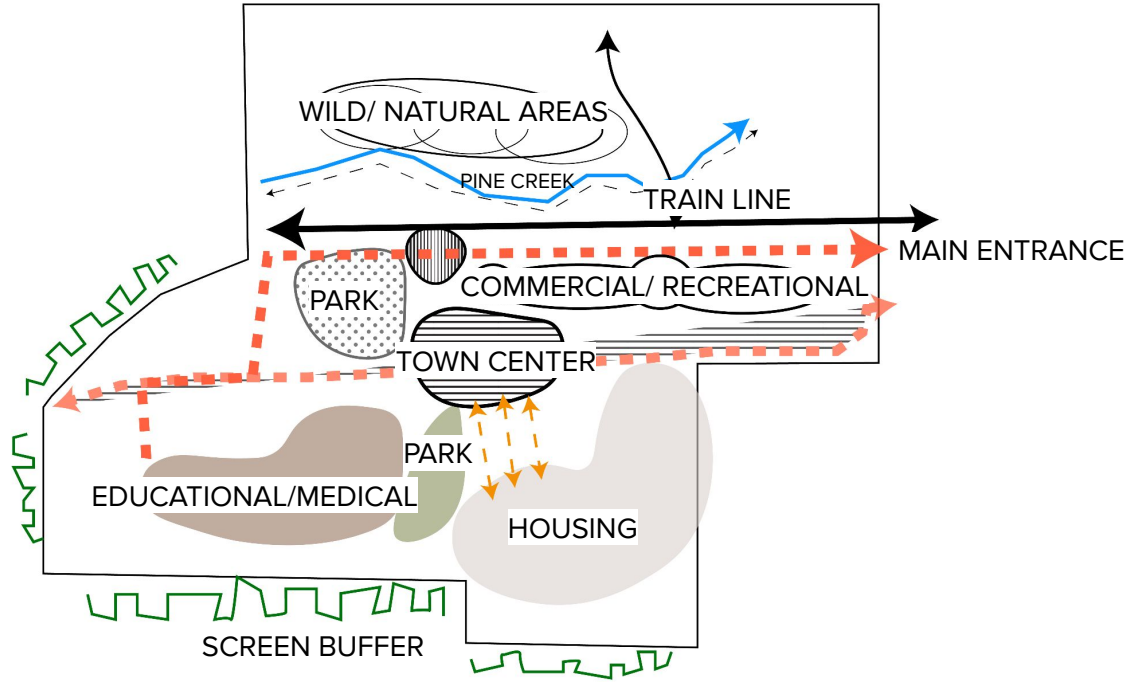

# MASTERPLAN



# MASTERPLAN





# MASTERPLAN

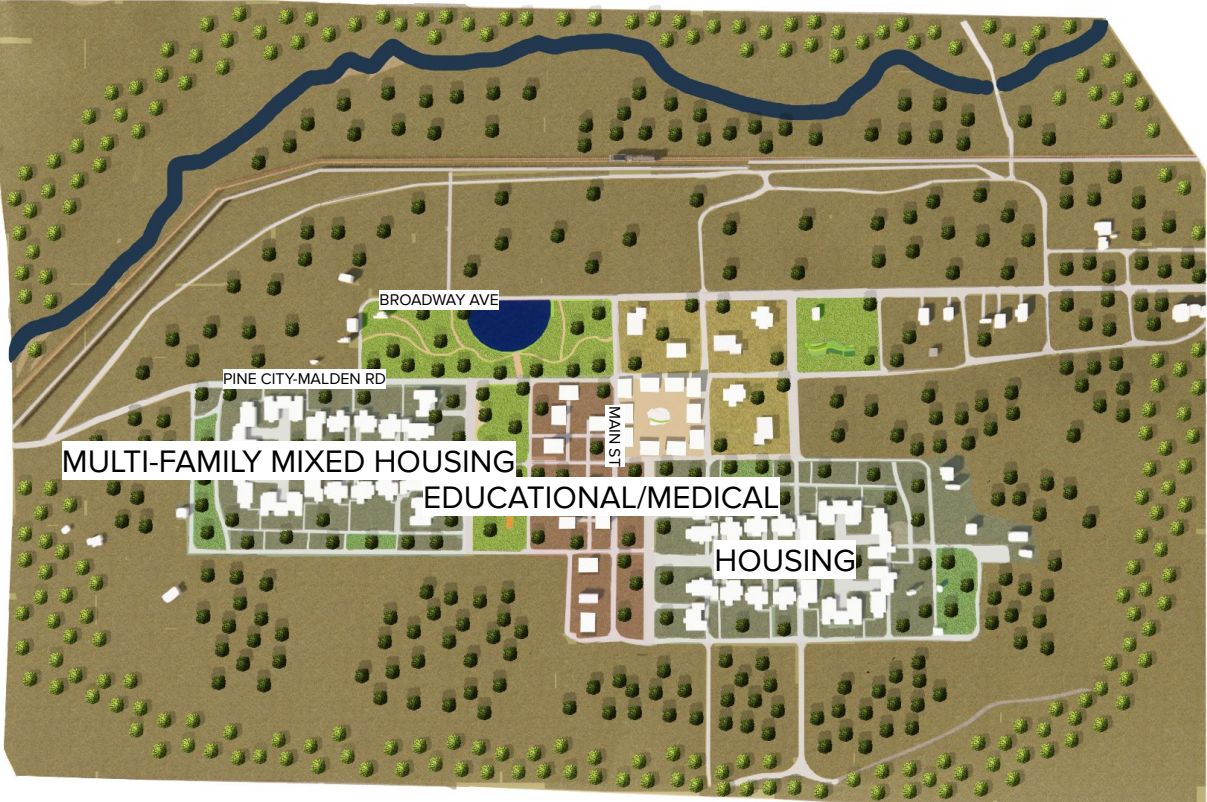

# MASTERPLAN

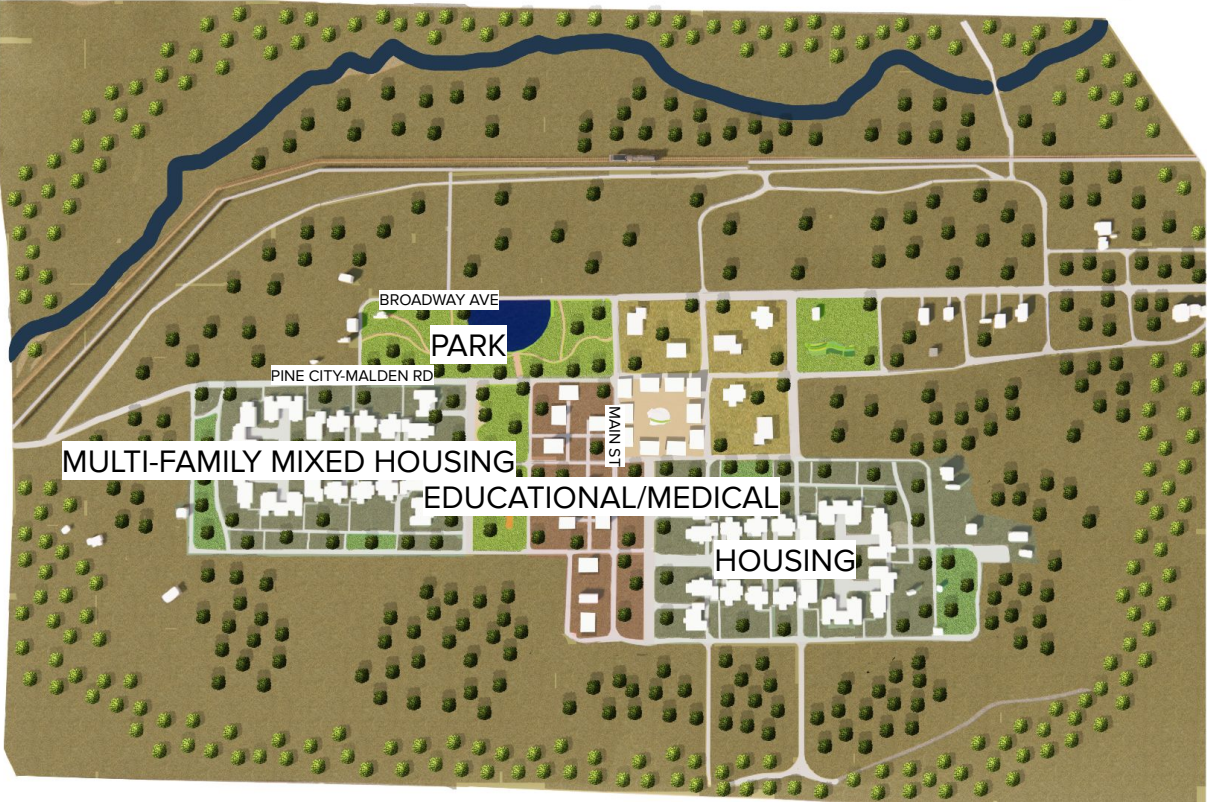



# MASTERPLAN

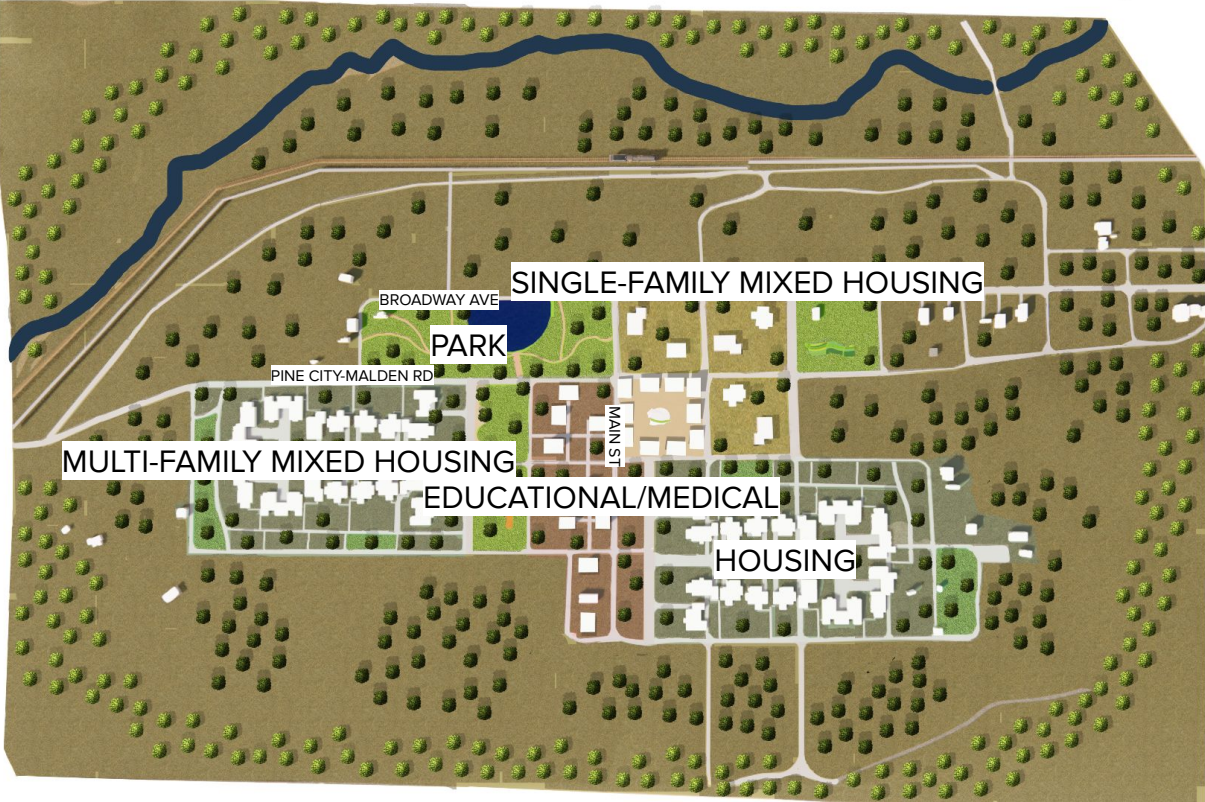

# MASTERPLAN

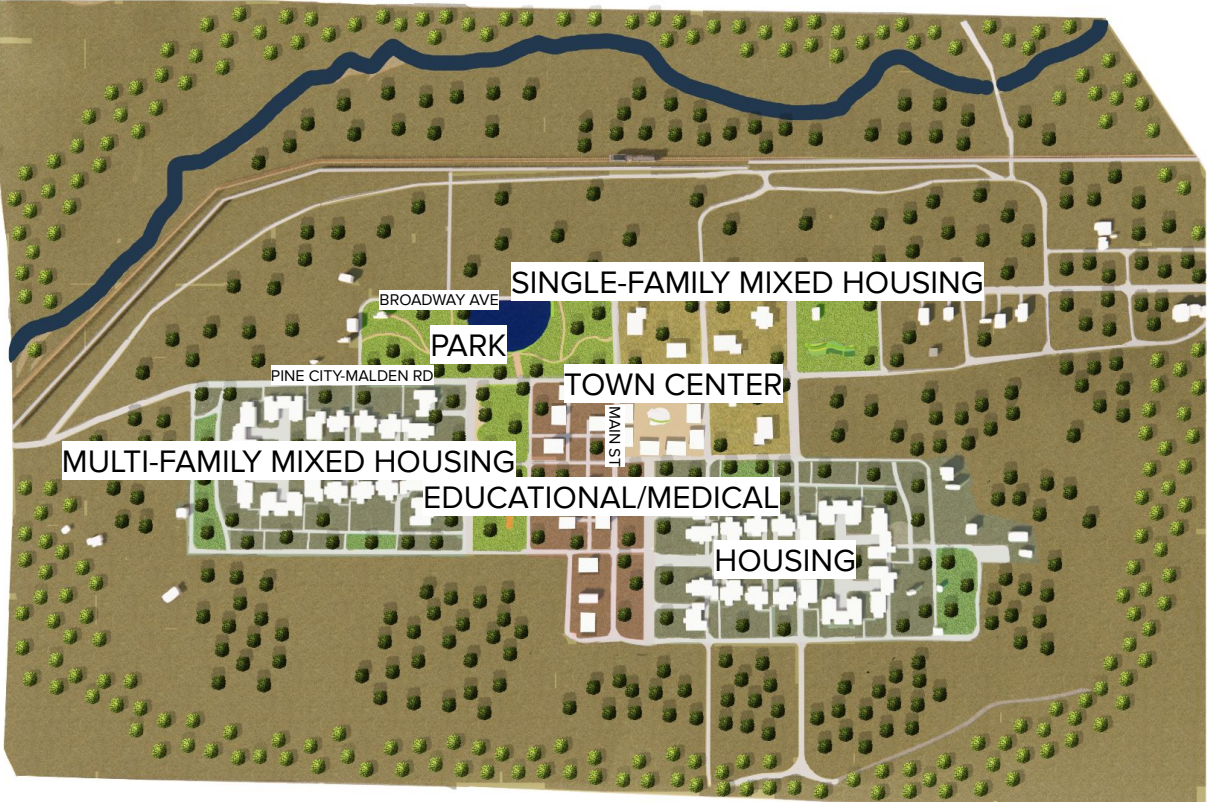



# MASTERPLAN

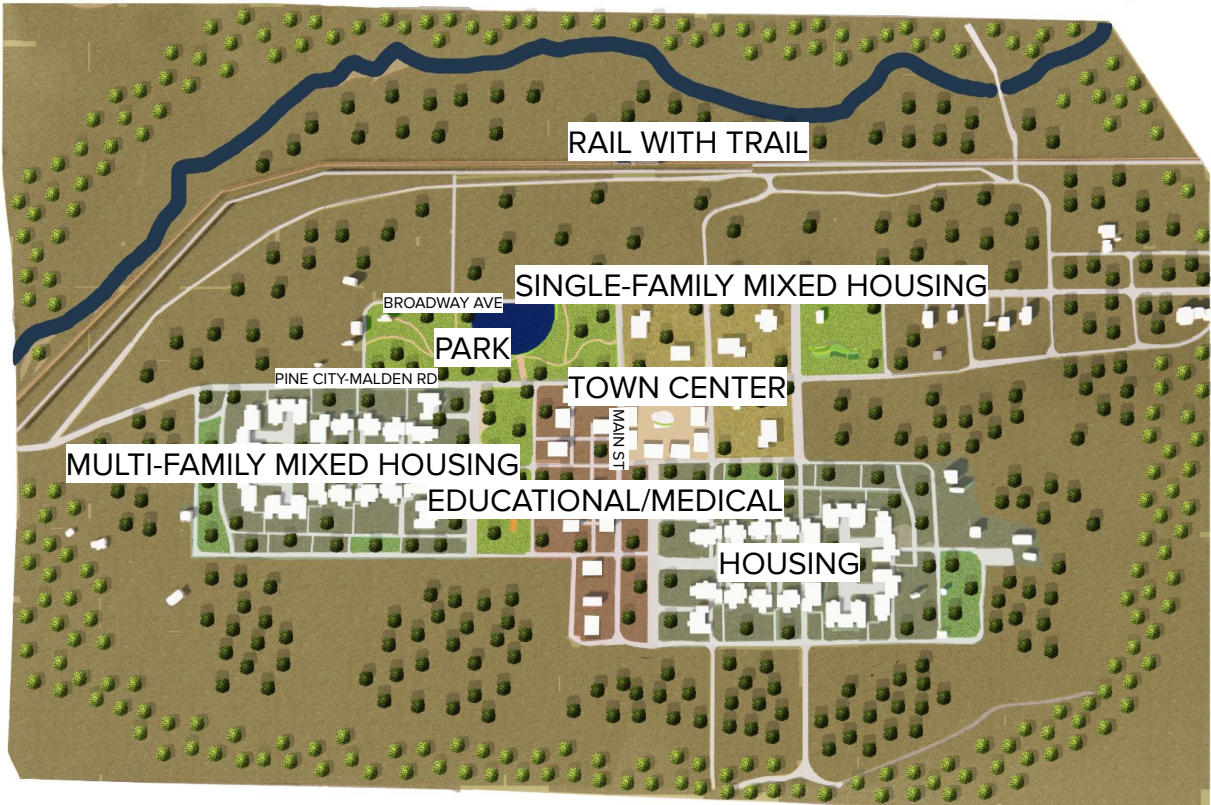

# HOUSING





# HOUSING

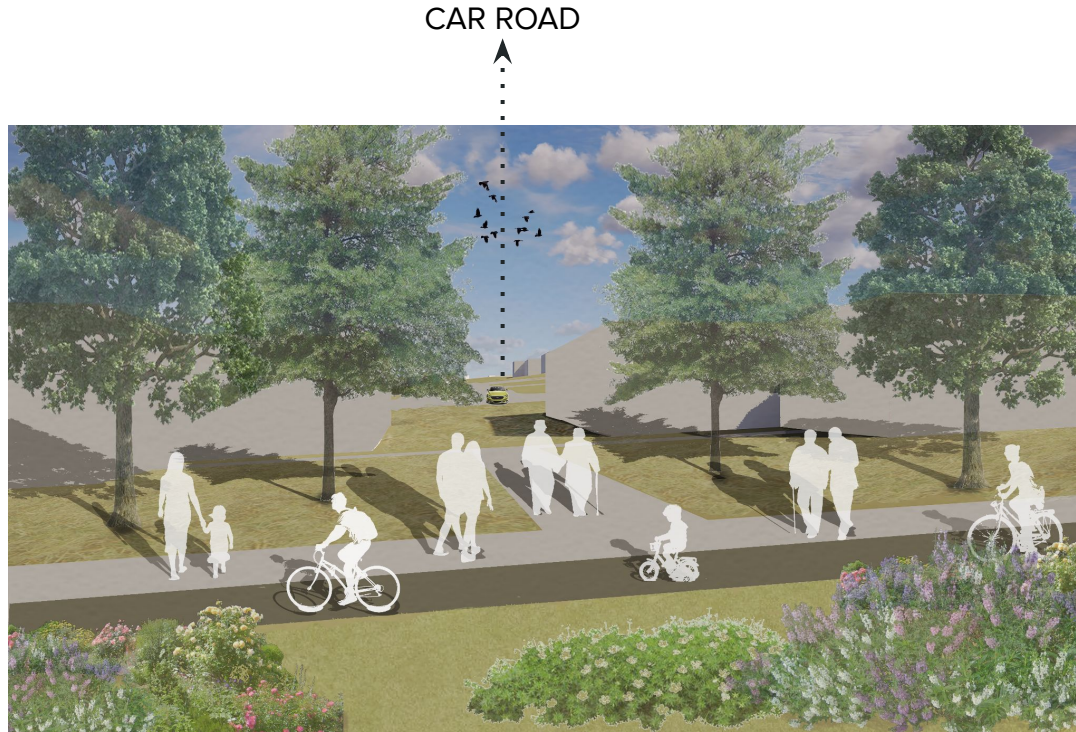

# HOUSING

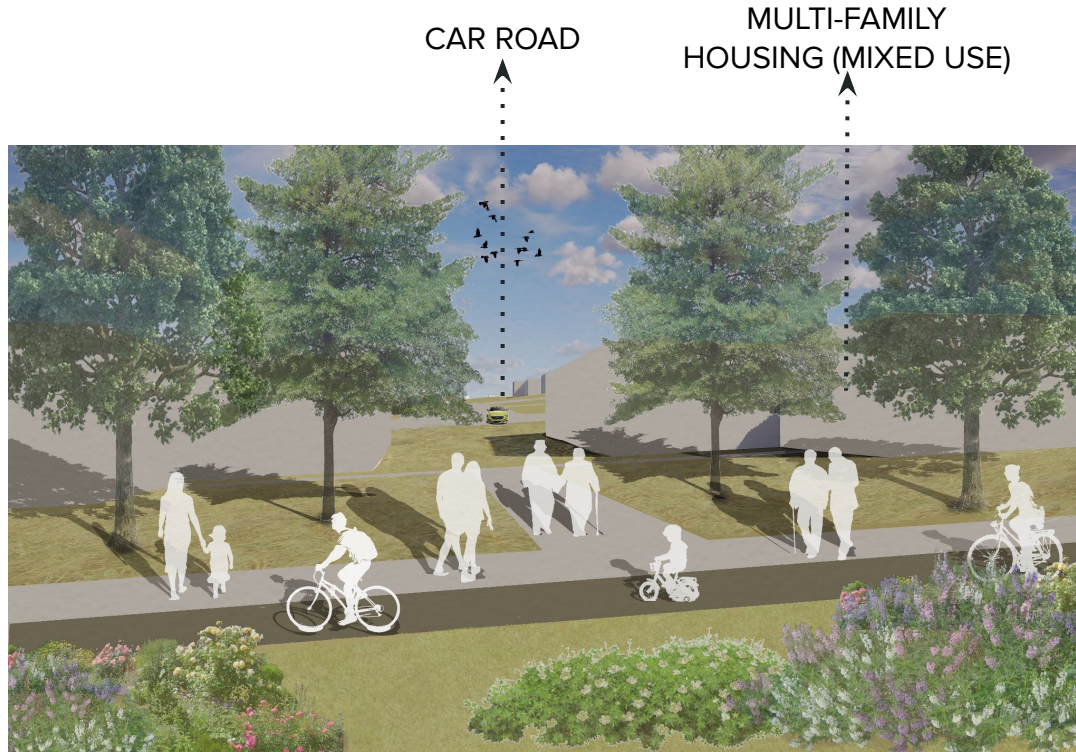

# HOUSING

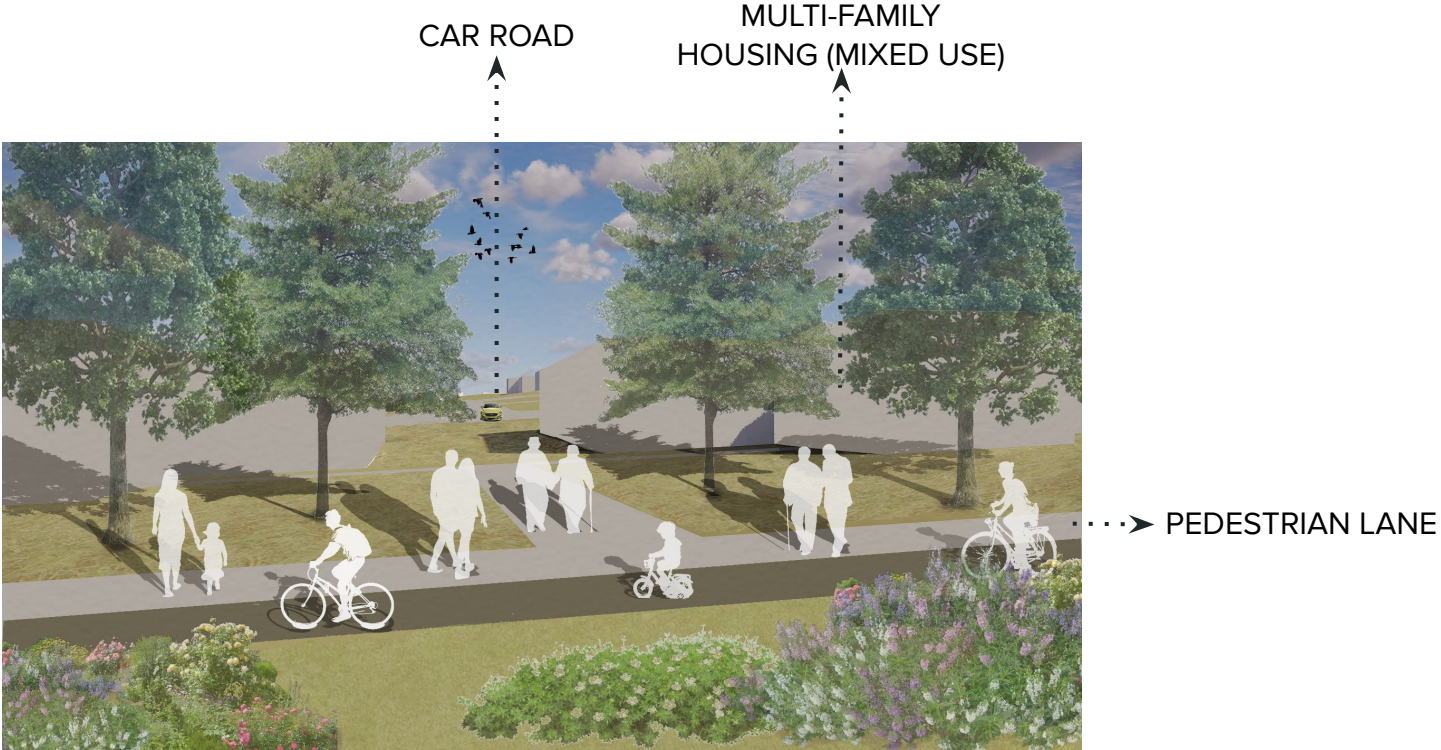



# HOUSING

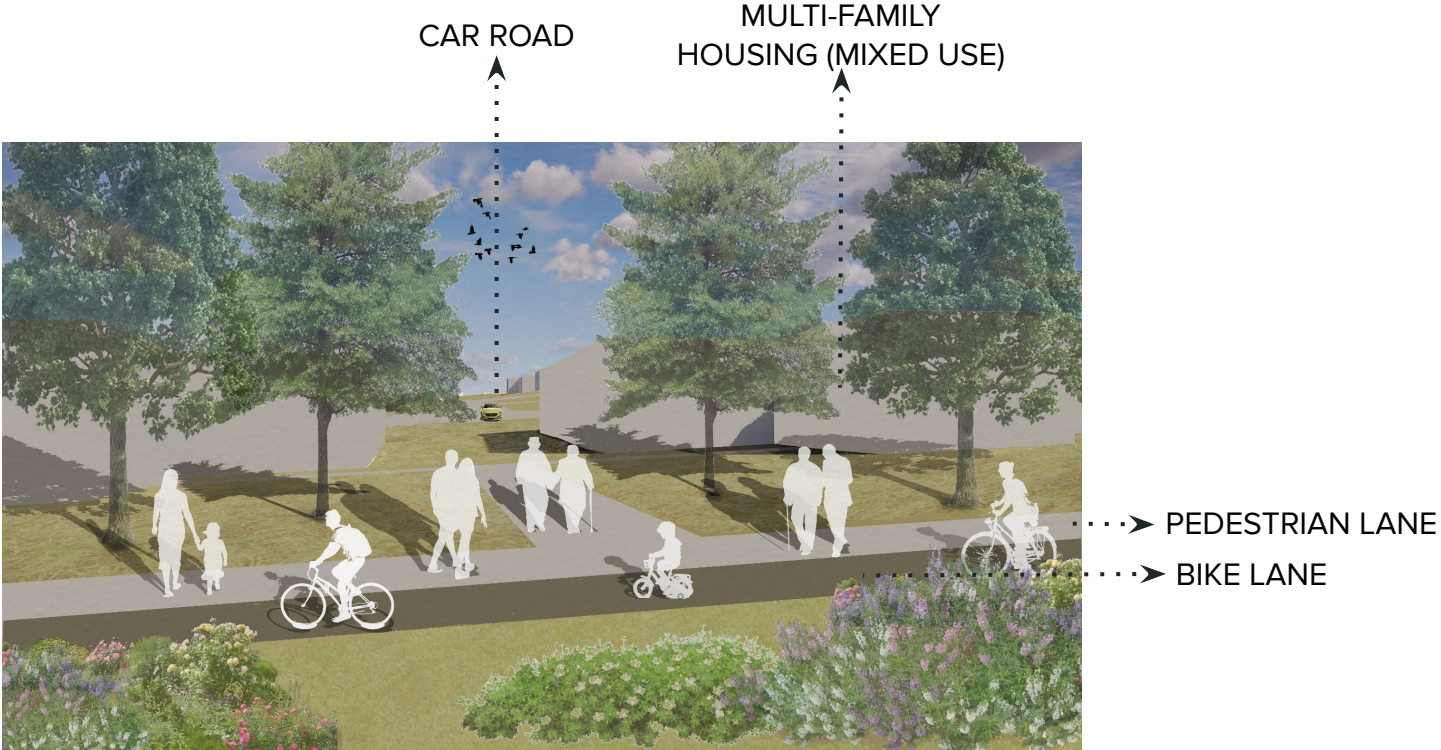

# HOUSING

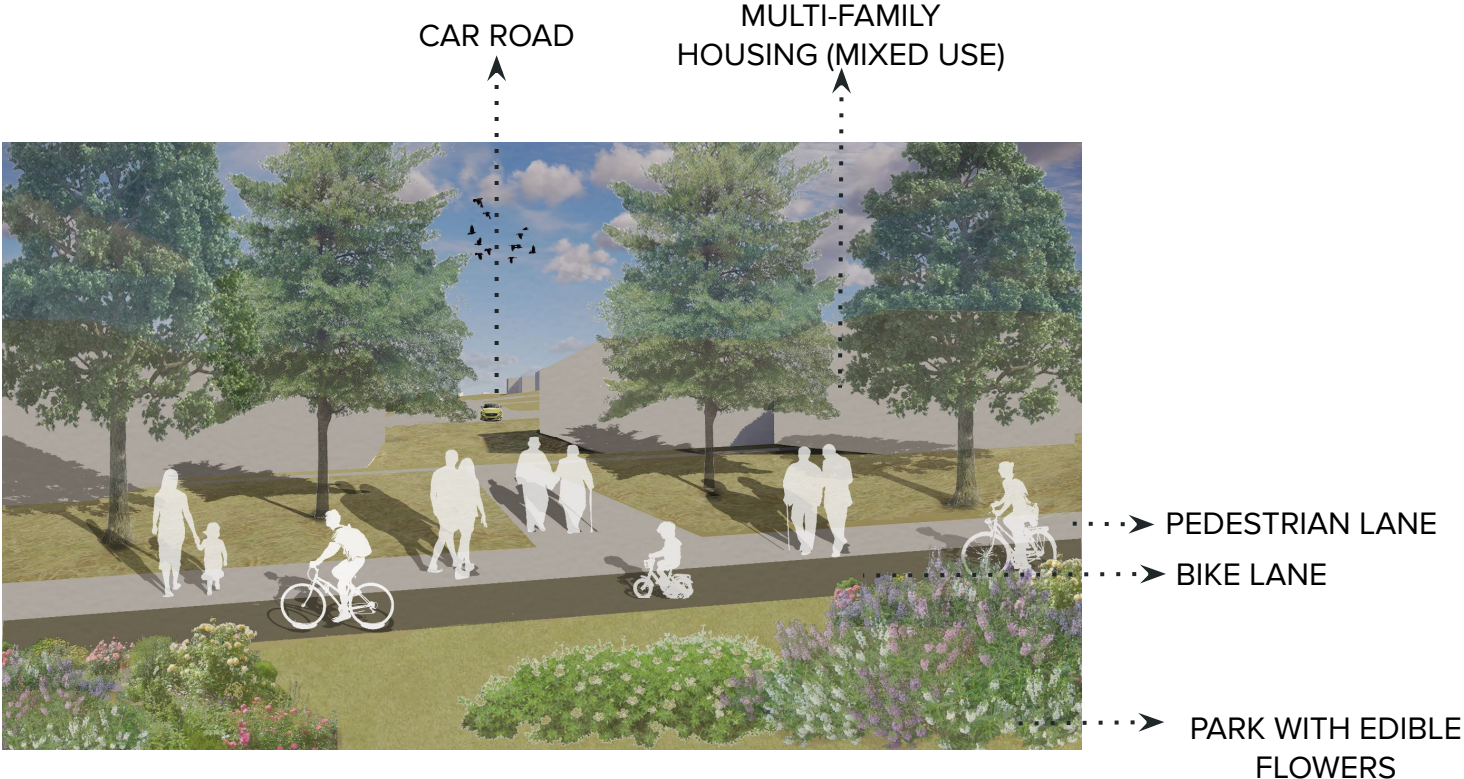

# PARK





# PARK

WOODEN  
PLATFORM



# PARK

MEDICAL AND  
EDUCATIONAL



WOODEN  
PLATFORM

# PARK

MEDICAL AND  
EDUCATIONAL



WOODEN  
PLATFORM

PLAYGROUND



# PERMACULTURE

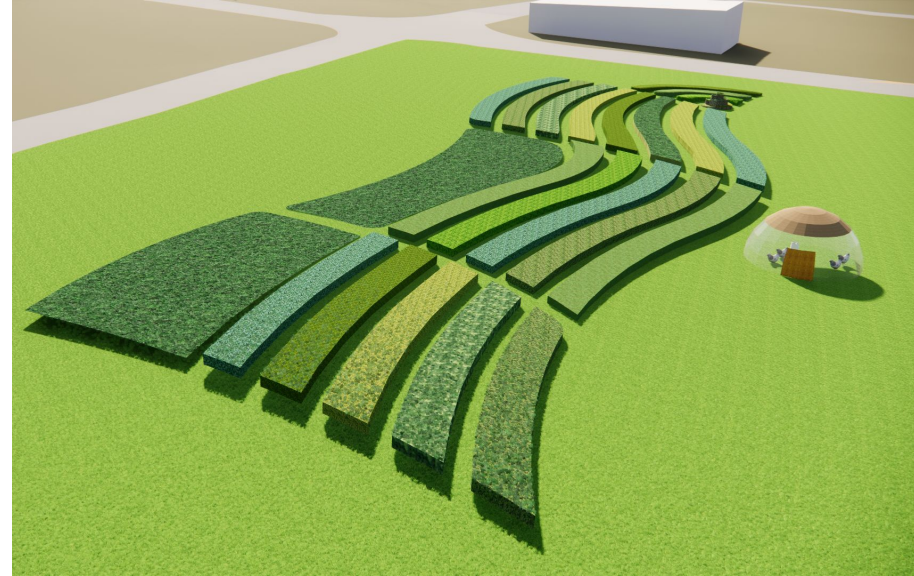

# PERMACULTURE

- Permanent agriculture

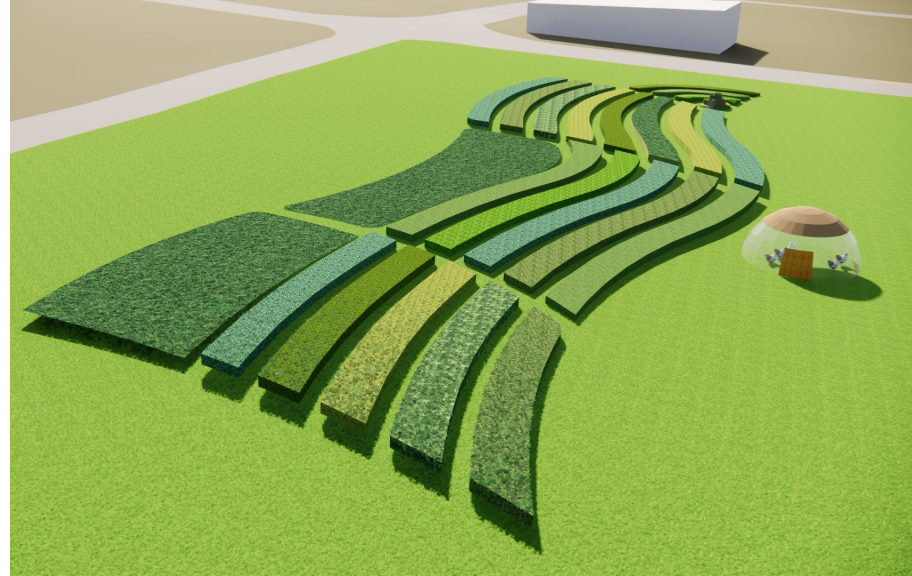

# PERMACULTURE

- Permanent agriculture
- KEY PRINCIPLES:
  - Caring for the earth
  - Caring for people

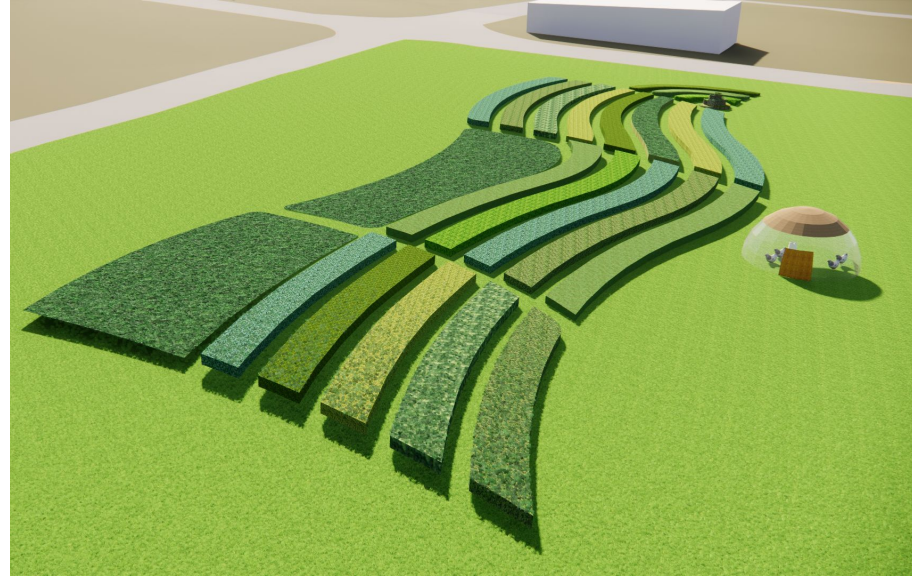



# PERMACULTURE

- Permanent agriculture
- KEY PRINCIPLES:
  - Caring for the earth
  - Caring for people
- Design edible landscapes/food gardens

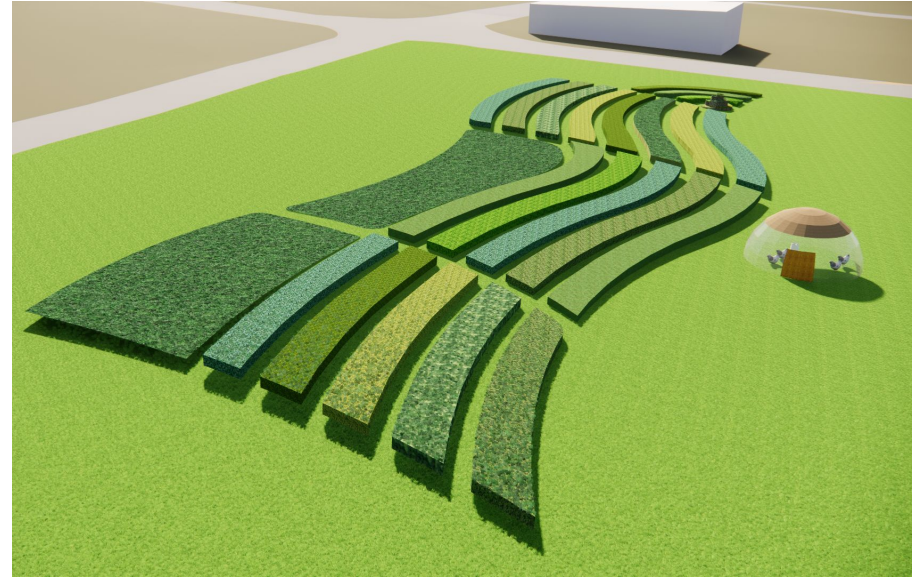

# PERMACULTURE

- Permanent agriculture
- KEY PRINCIPLES:
  - Caring for the earth
  - Caring for people
- Design edible landscapes/food gardens
- Improve and support local ecosystem

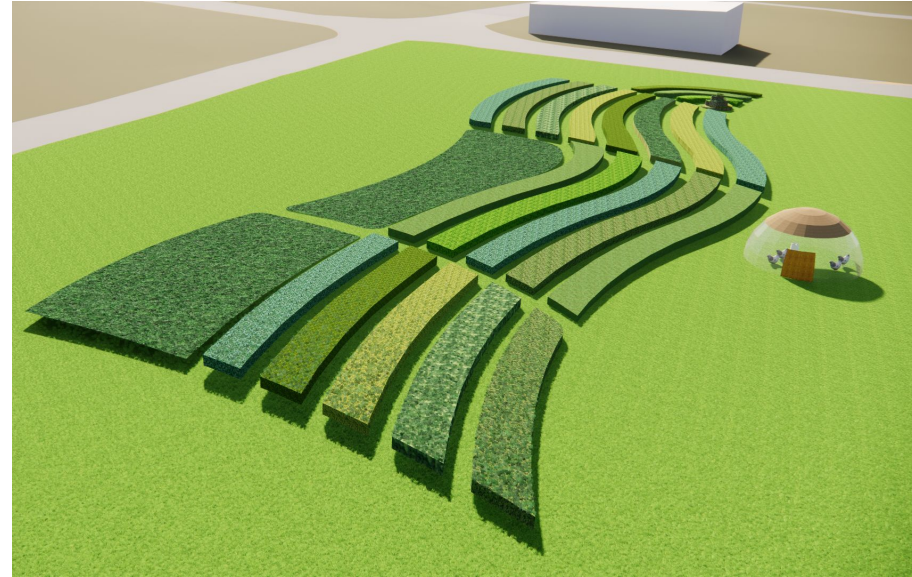

# PERMACULTURE



# PERMACULTURE





# PERMACULTURE



# PERMACULTURE

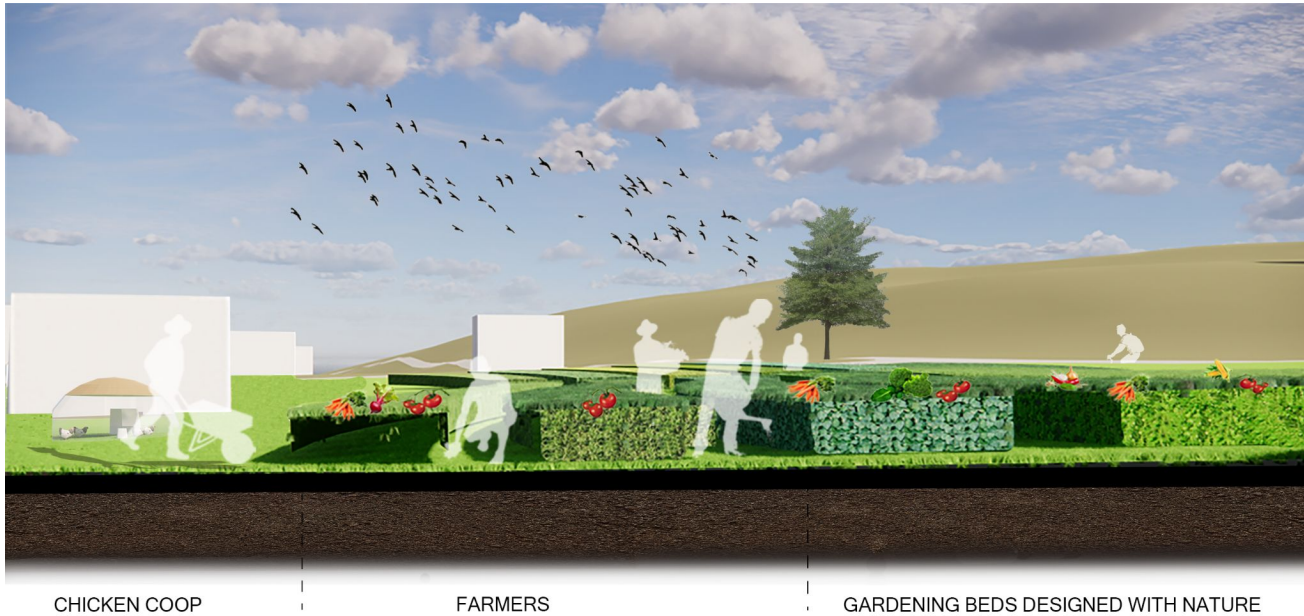



# TOWN CENTER



# TOWN CENTER

SHADE



# TOWN CENTER

MIXED-USE  
BUILDINGS

SHADE



# TOWN CENTER

MIXED-USE  
BUILDINGS

PHOENIX  
STATUE

SHADE





# TOWN CENTER

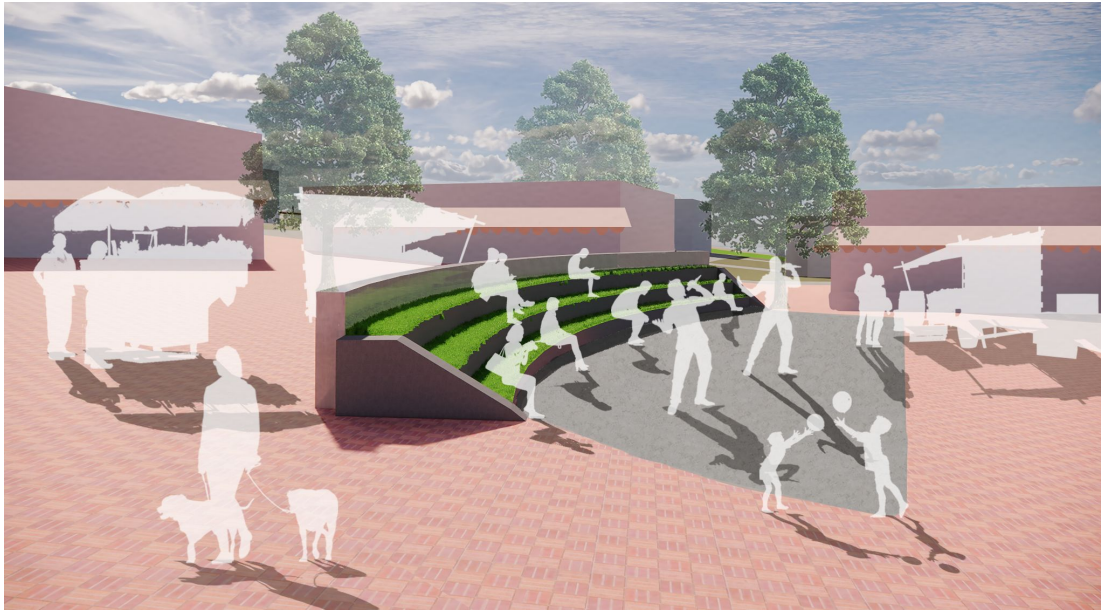

# TOWN CENTER

AMPHITHEATER

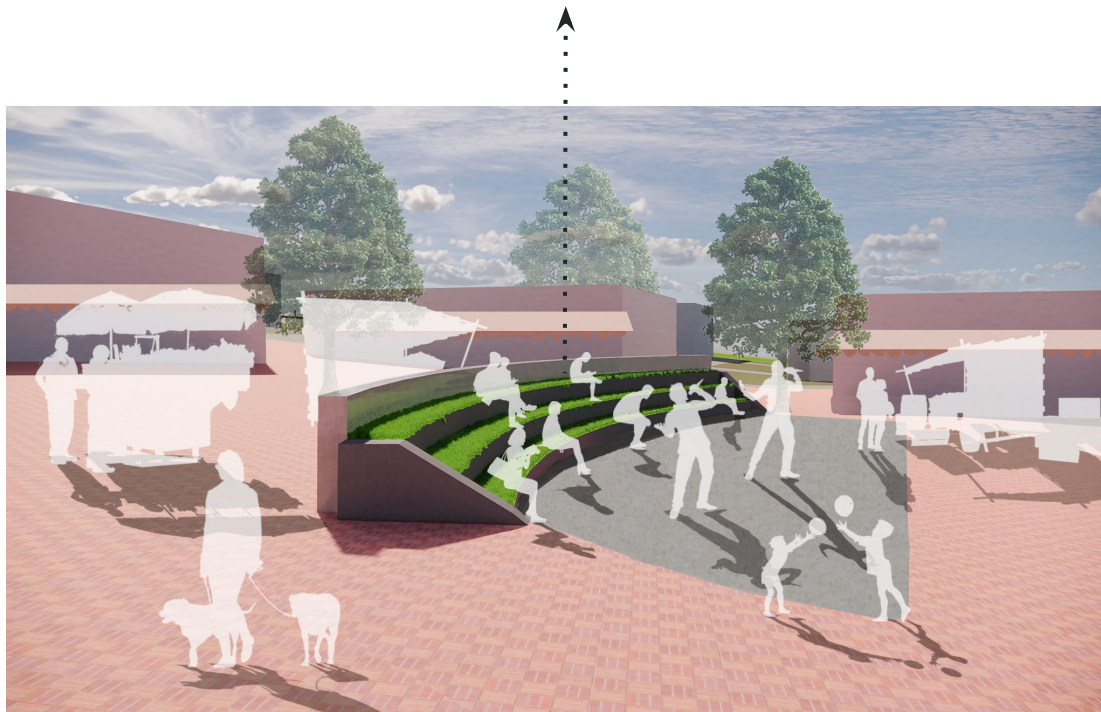

# TOWN CENTER

AMPHITHEATER

FARMERS'  
STALLS

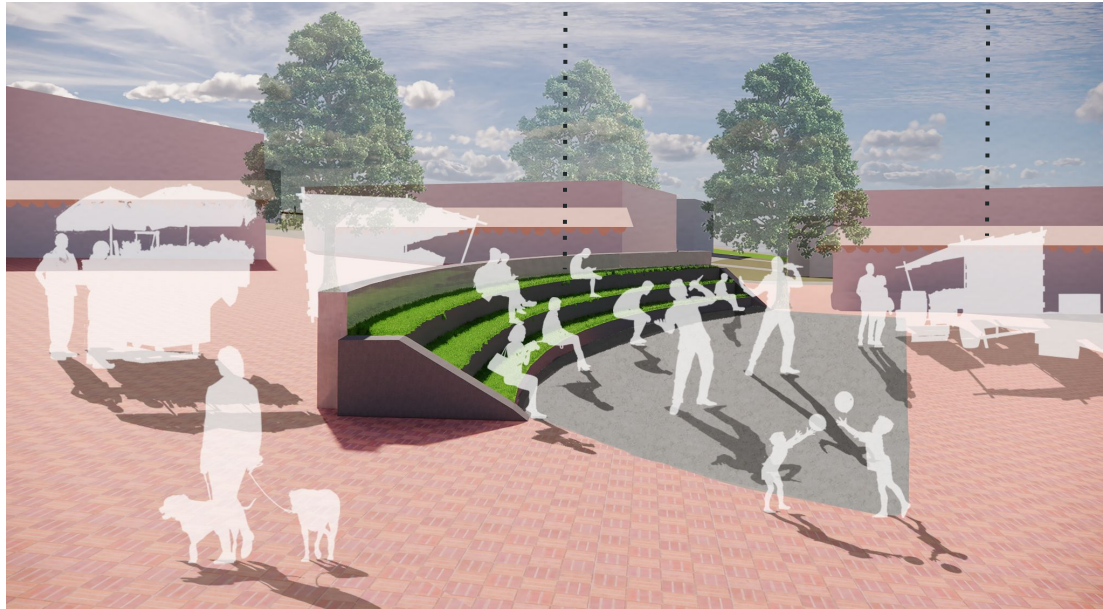

# RAIL WITH TRAIL

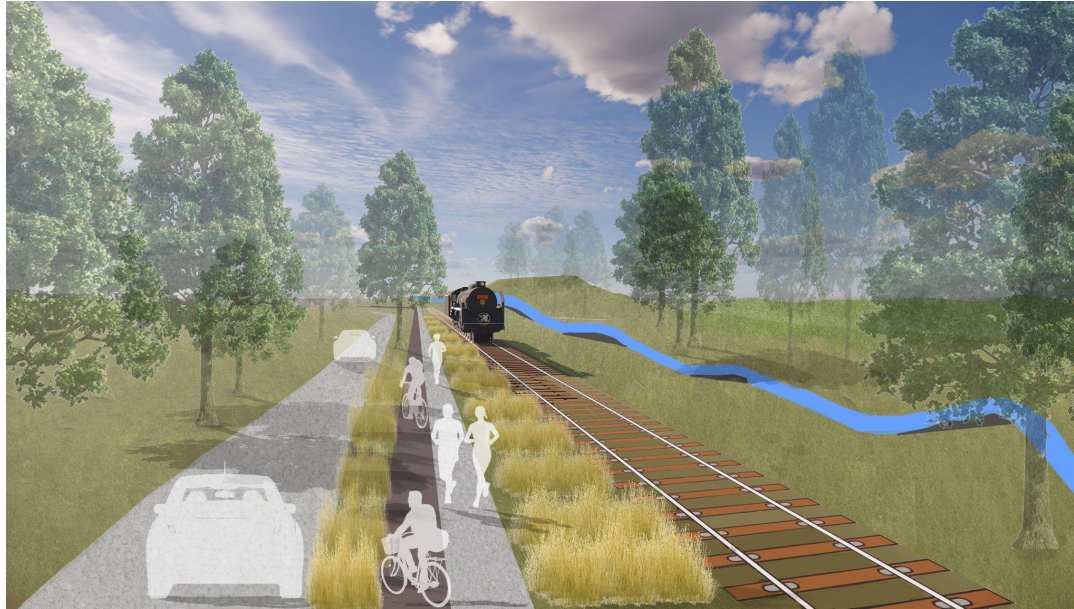



# RAIL WITH TRAIL

CAR LANE ←

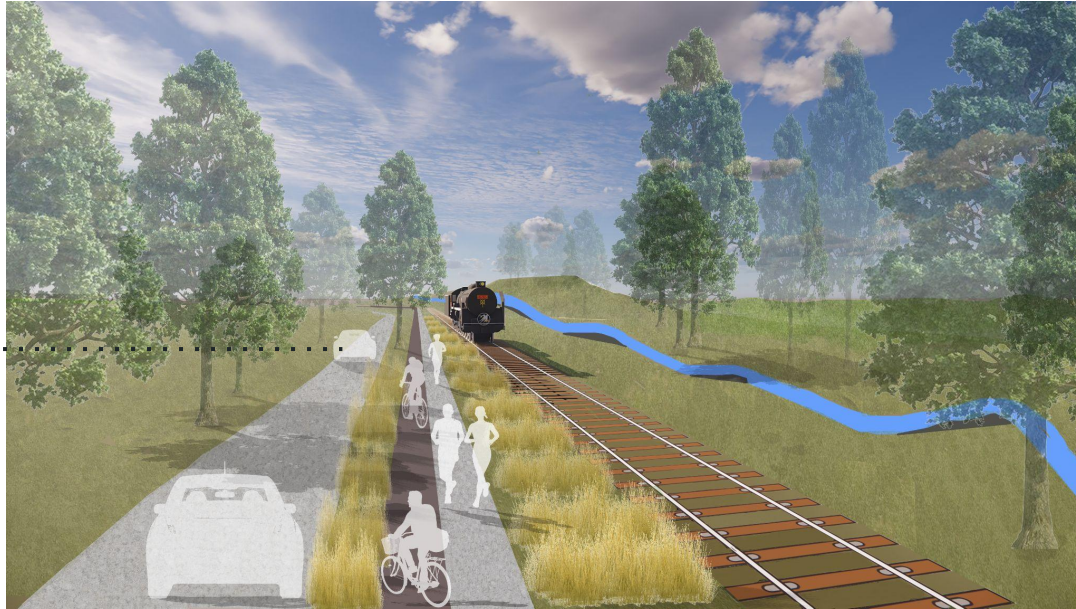

# RAIL WITH TRAIL

CAR LANE ←  
BIKE AND PEDESTRIAN  
LANE ←

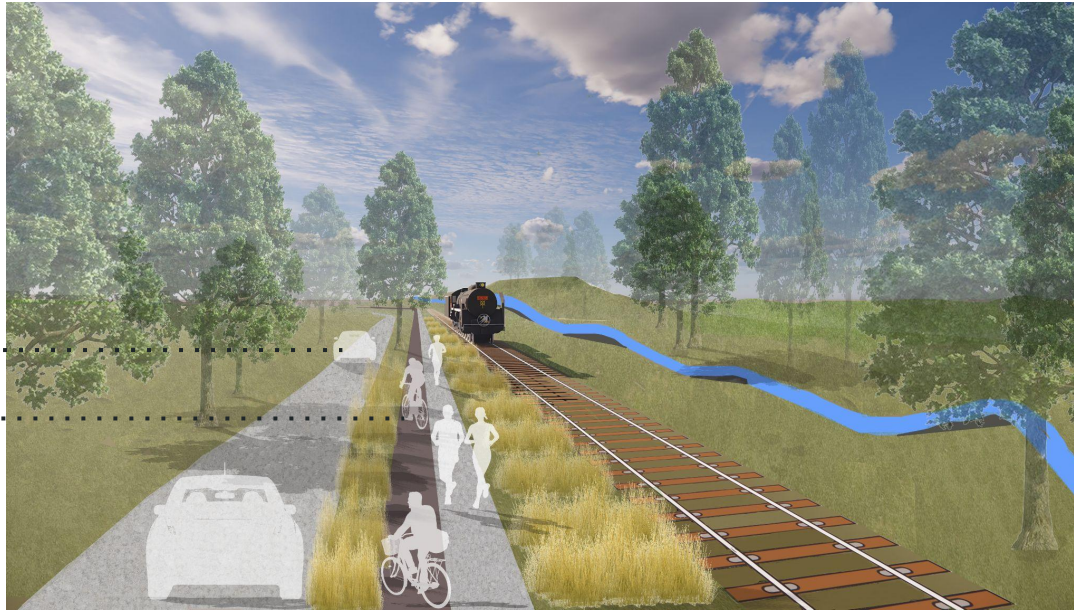

# RAIL WITH TRAIL

RAIL LINE

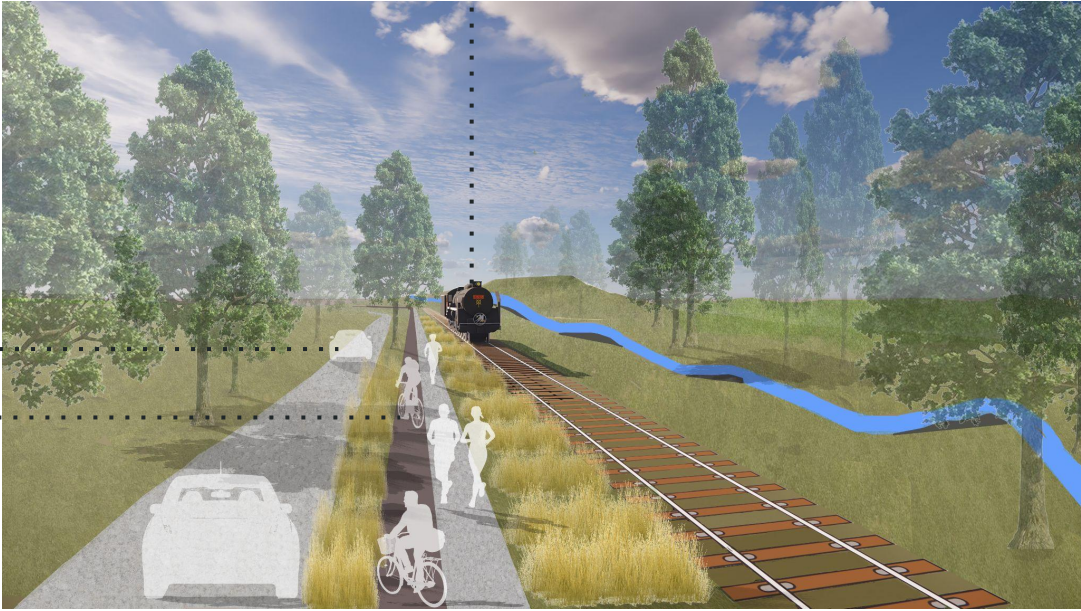

CAR LANE



BIKE AND PEDESTRIAN  
LANE





# THANK YOU

